

Insert

1. Insert the EXOSEAL® Device into the sheath, advance to the black marker band.
2. Retract the sheath back to the wirecrowing.
3. Check for pulsatile flow. Continue to retract the sheath compressing the green wirecrowing against the white handle. A "click" will be heard.

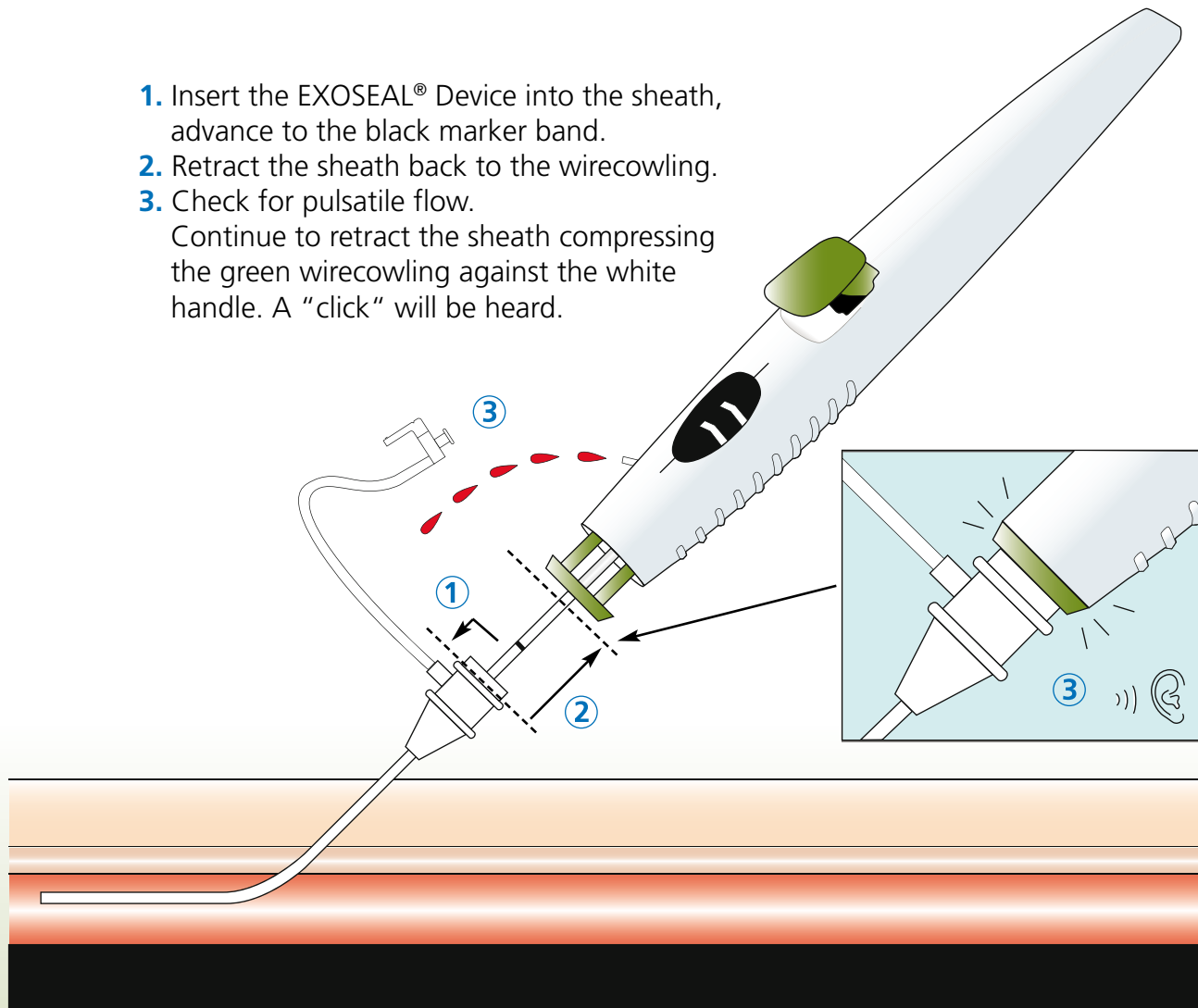

Retract

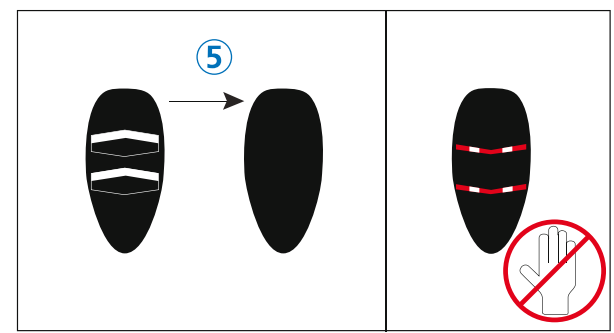

4. Retract the EXOSEAL® Device and sheath together with the left hand, maintaining a 30°-45° angle with the right hand. Watch the bleed-back indicator for a significant reduction in pulsatile flow.
5. When the flow significantly changes and becomes non-pulsatile, slow your speed of retraction and watch for the indicator window to change to all BLACK.

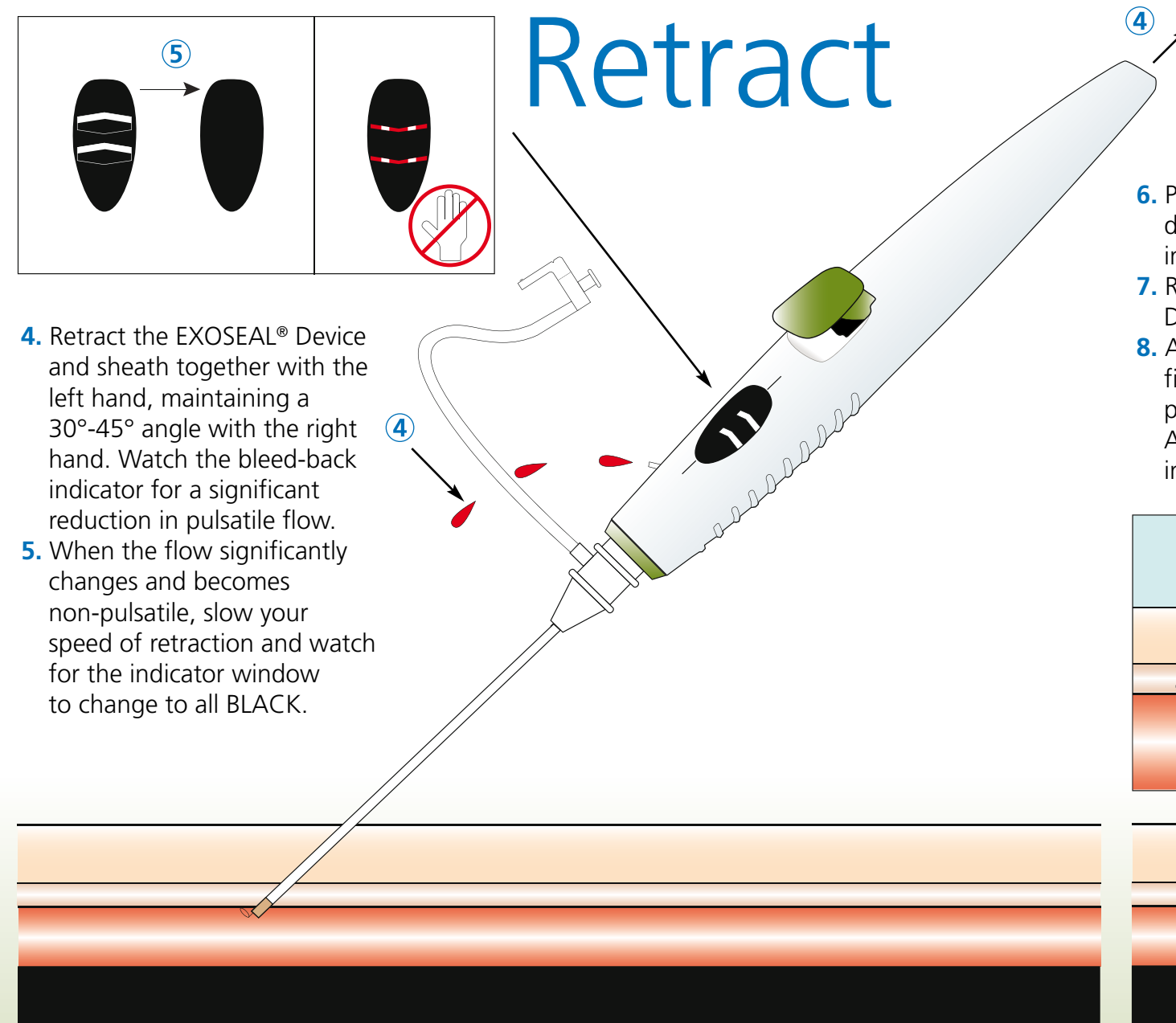

Deploy

6. Press the green plug deployment button fully into the white handle.
7. Remove the EXOSEAL® Device and sheath together.
8. Apply light non-occlusive finger tip pressure at the puncture site for 2 mins. Apply a dressing per institutional protocol.

